

TOTAL SOLUTIONS FOR MOVEMENT

**PANORAMIC
ELEVATOR**



**FRANKSON[®]
GROUP**

Elevator & Escalator

- www.franksonelevator.com
- www.frankson.in
- www.franksongroup.com

FRANKSONGROUP

Safety, Comfort, Technology

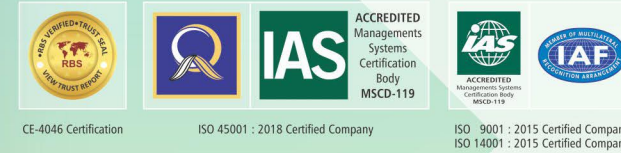

About Us :

In the Year 1984 we started a Company named " KINGFISHER INDIA ELEVATOR ". Initially ,We were supplying all types of Elevator in some cities of India. In the Year 2001, we made an Elevator Factory in a 2 Storied Building covering an area of 21280 Sq. Feet near Kolkata.

With the intension of making our Company with a Brand Name We started FRANKSON BRAND NAME with Registered Trademark, CE, ISO 9001-2008, ISO-18001-2007 & other Certifications in the Year 2008. Then we started Joint Venture in Technology Replacement with World Famous Branded Elevator Companies of China, Korea & European Countries.

FRANKSON GROUP is a growing Company. To provide better & prompt service & customer satisfaction , we started making a World Class Category Elevator Escalator & Travelator factory at Baduria covering an area of 57580 Sq Feet with four storied Decorative Office Complex Building. Now, We are importing 60% of the Materials from China , Korea , Europe & the rest 40% Materials are manufacturing in our own factory & then the Materials are being tested & assembled by our Qualified & Competent Engineer & then these Materials are installed in our Project site.

For Highrise Buildings , we are importing complete Lift Material from our associate Companies from China , Korea & European Branded Companies. You can compare our Lift Material with any Internationally reputed Branded Companies & this is our challenge. We have four types of Shipments & these are 1) Indian Shipment, 2) Chinese Shipment , 3) Korean Shipment, 4) European Shipment. As per the Customer's Project budget, we provide the Shipment.

Frankson Group (An ISO 9001-2008, ISO 18001-2007 & CE Certified Company) is a well known name in industry engaged in manufacturing, exporting, supplying and distributing of all types of high quality Elevators Escalator & Travelator. Our range of products includes Passenger lifts both with machine room and MRL, Home Lifts, Glass Panoramic Lifts, Hospital Lifts, Freight Lifts, Automobile Lift, Goods Lift, Hydraulic Lift, Escalators & Travelators. We are working on all cities of India & Nepal, Bhutan Bangladesh, Sri Lanka, Cambodia. Our Planning is to work on other Countries over the World. We have built a well developed infrastructure that is installed with latest machines and other related facilities that help us in fabricating the wide range of Lifts.



India Eastern Zone Second Factory
(38520 Sq. Ft. Area)



India Eastern Zone Third Factory Having World Class Category Under Construction
(93234 Sq. Ft. Area)

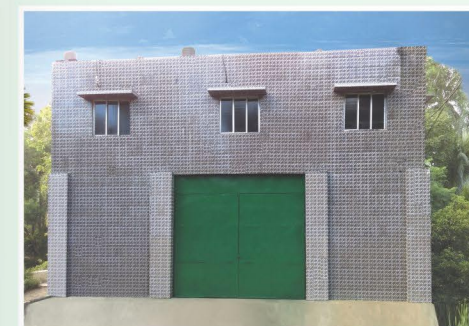

India Eastern Zone First Factory
(21280 Sq. Ft. Area)

Panoramic Elevator (Capsule Elevator)



Enjoy the View

Glass capsule elevators give an upscale, attractive feel to offices, shopping malls, multiplexes and other prestigious buildings. These lifts owe their stunning looks to the large glass viewing panels which provide entertaining ride to passengers.

Capsule elevators work just as well as small personal lifts for private homes as they do in large office and commercial buildings. Installation on the exterior face of the building or in the lobby will totally change the look of a building. And of course, they incorporate state-of-the-art technology.



www.franksonelevator.com

MR Type (Machine Room) Capsule Elevator



Features of the Capsule Elevators

- ▶ Made from S.S./M.S. with vision panel.
- ▶ Color-Powder coated, Elegant looks, Light in weight and variable speed.
- ▶ Controller Full Proof to voltage (PLC or Solid state) with fullycollective- selective system.
- ▶ AC VVVF drive for jerk free operation & for variable speed.
- ▶ Overload indication and Auto Door announcing system.
- ▶ Avail Inverter facility for single base at time of Power failure.
- ▶ Push Button Luminous type highly attractive as well as durable.
- ▶ Facility Floor Position Indication at the floors as well as in cabin.

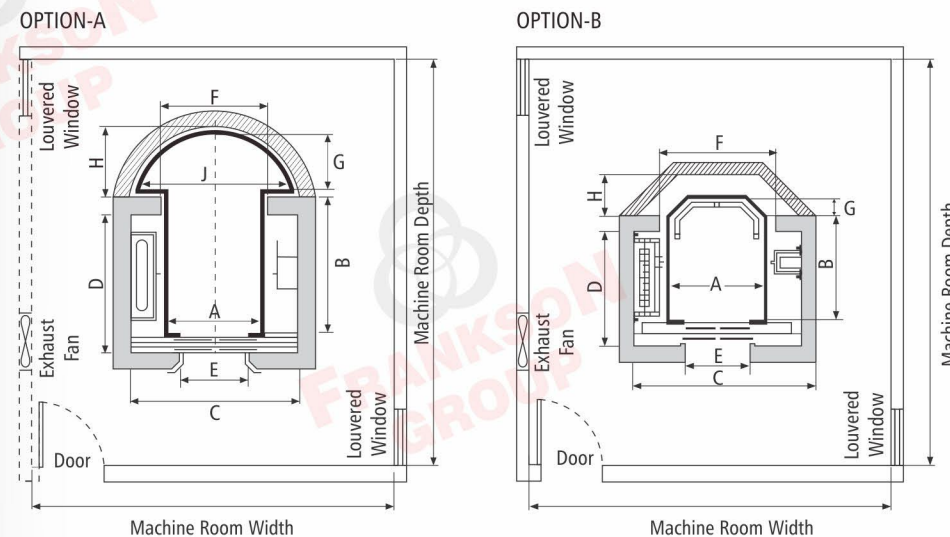

OPTION - A

PER SON	Load Kgs.	Car Inside				Lift Well				Entrance
		A	B	J	G	C	D	F	H	
10	680	1100	1300	1400	650	2200	1325	1330	1100	800
13	884	1200	1400	1550	700	2400	1425	1430	1100	900
16	1088	1300	1500	1700	750	2800	1525	1530	1200	1000

OPTION - B

Per son	Kgs.	Car Inside				Lift Well				Entrance
		A	B	G	C	D	F	H		
10	680	1250	1300	250	2200	1450	1480	580	800	
13	884	1400	1400	300	2400	1550	1630	650	900	
16	1088	1550	1500	350	2800	1780	1650	790	1000	

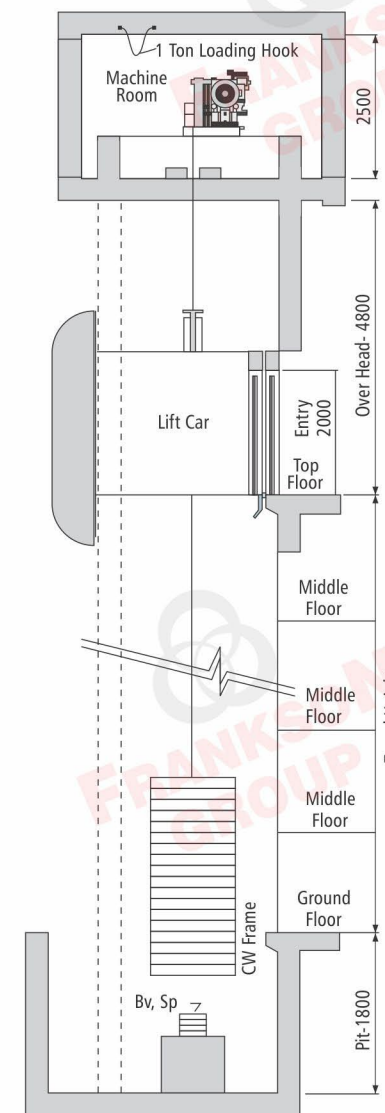

MRL Type (Machine Roomless) Capsule Elevator

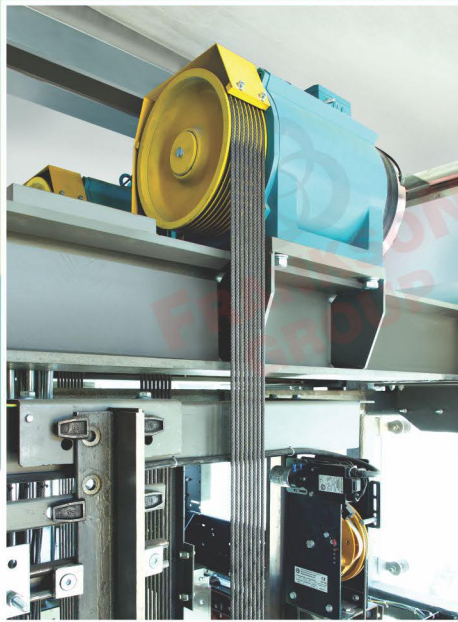

40%
ENERGY SAVE
2VAE
ELEVATOR

It saves 25% of total elevator equipment area. It reduces 40% of space occupation.

FRANKSON GROUP
Elevator & Escalator

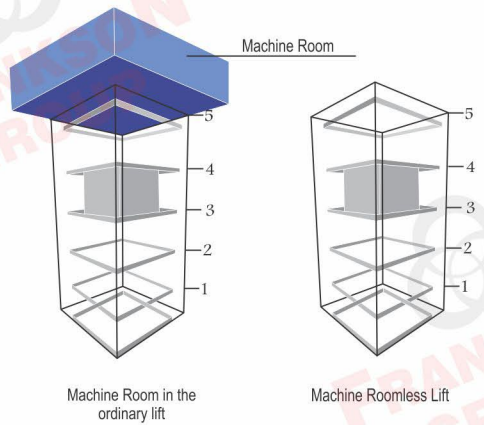
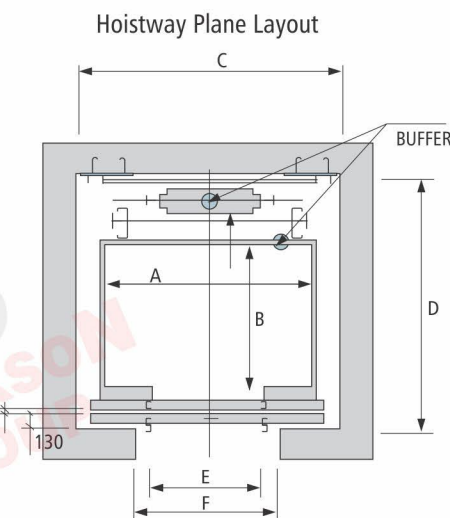
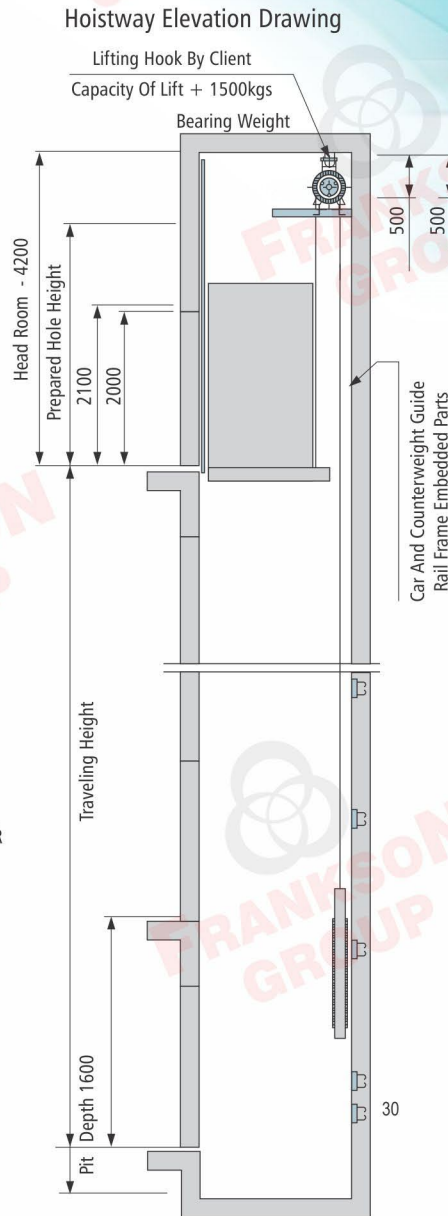

MRL ELEVATOR

Capacity		Car Inside		Lift Well		Clear Entrance	Clear Opening At Landing	
Person	Kgs	A	B	C	D	E	F Auto Door	F Manual Telescopic
6	408	1200	900	1800	1400	700	780 / 2100	1450 / 2350
8	544	1300	1100	1900	1600	800	880 / 2100	1600 / 2350
10	680	1300	1300	1900	1800	800	880 / 2100	1600 / 2350
13	884	1600	1400	2200	1900	900	980 / 2100	1700 / 2350

www.franksonelevator.com

Hydraulic Type Capsule Elevator



FRANKSON GROUP
Elevator & Escalator



Rope Type Single Cylinder

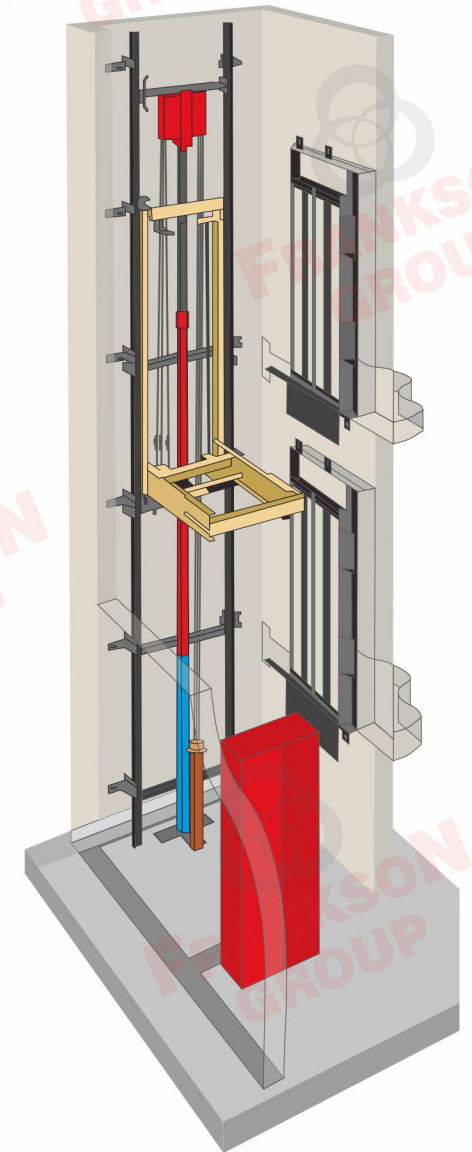
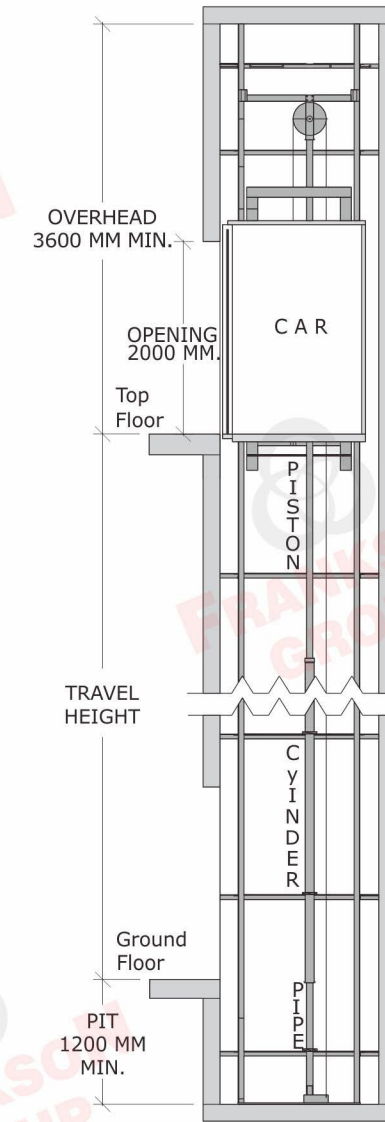
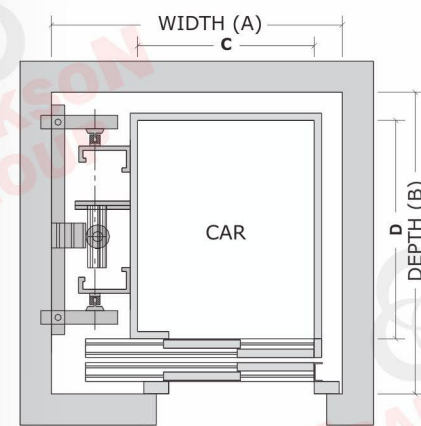

TELESCOPIC OPENING AUTOMATIC DOOR LIFT

Persons	Capacity Kgs.	Shaft-W (A)	Shaft-D (B)	Car-W (C)	Car-D (D)
3	225	1300	1300	750	900
4	300	1350	1450	800	1050
5	375	1500	1500	950	1100
6	450	1600	1550	1050	1150
8	600	1600	1800	1300	1100
10	750	1700	1950	1130	1550
12	900	1800	2050	1230	1650
15	1125	1950	2400	1230	2000
20	1500	2100	2800	1350	2400

Pit : 1200 mm | Overhead : 3600 mm Maximum Travel : 15 Meter

Panoramic Cabins



**FRANKSON[®]
GROUP**

Elevator & Escalator

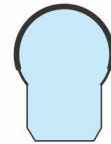

**FGLEC-1035
Round Cabin**

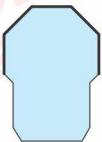

**FGLEC-1036
Octagonal Cabin**



- Ceiling** : Painted steel sheet
- Lighting** : Fluorescent lighting through circular, milky-white acrylic plate and downlights
- Wall and Doors** : Stainless-steel, hairline-finish
- Handrail** : Single line of hairline-finished stainless steel pipe
- Mullions** : Stainless-steel, Hairline finish

- Ceiling** : Painted steel sheet
- Lighting** : Downlights
- Wall and doors** : Stainless-steel, hairline-finish
- Handrail** : Single line of hairline - finished stainless steel pipe
- Mullions** : Stainless-steel, Hairline finish

Panoramic Cabins



FGLEC-1037
Square Cabin



- Ceiling** : Painted steel sheet and glass
- Lighting** : Downlights
- Wall** : Stainless-steel, hairline - finish
- Handrail** : Single line of hairline-finished stainless steel pipe
- Mullions** : None

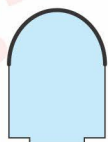

FGLEC-1038
Horseshoe Cabin



- Ceiling** : Painted steel sheet
- Lighting** : Fluorescent lighting through circular, milky-white acrylic plate and downlights
- Wall and Doors** : Stainless-steel, hairline-finish
- Handrail** : Single line of hairline-finished Stainless steel pipe
- Mullions** : Stainless-steel, Hairline finish

Panoramic Cabins

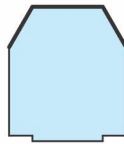

FGLEC-1039
Clipped Corner Cabin



- Ceiling** : Painted steel sheet
- Lighting** : Downlights
- Wall** : Stainless-steel, hairline-finish
- Handrail** : Single line of hairline-finished
Stainless steel pipe
- Mullions** : Stainless-steel, Hairline finish

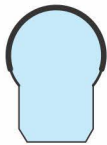

FGLEC-1040
Round Cabin



- Calling** : Painted steel sheet
- Lighting** : Fluorescent lighting through circular,
milky-white acrylic plate and down lights
- Wall and doors** : Stainless-steel, hairline-finish
- Handrail** : Single line of hairline-finished
stainless-steel pipe
- Mullions** : Stainless-steel, hairline-finish

COP & LOP



Elegant design.
Easy to operate.
An invitation to
passenger control.



Our control panels, for both car and landing, use technologically advanced products of modern design and functionality.

The integration of buttons, symbols, communication, alarms, security and key functions ensures the passengers is in full control. Total Elevators range of push button panels, both in the car and on the landing, are of the highest quality and can be mounted to suit any architectural requirements.



KCG 351



KXG 351



BC 163B



BX 165



Touch COP



Touch LOP



Glass COP



Glass LOP



KCG 311



KXG 311

Machines

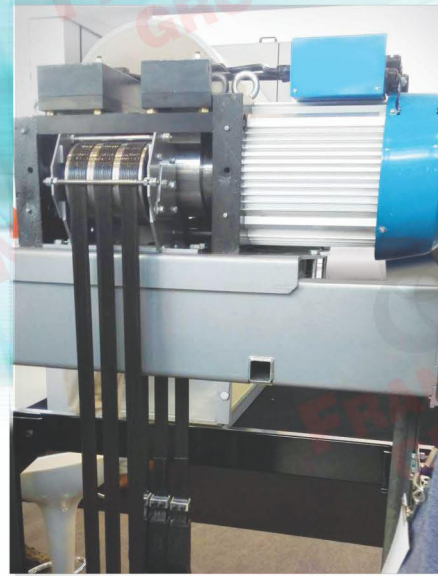

Belt Drive Machine

Using high quality gear drive machines and V3F Drives, these lift performance is of the highest standard

Geared Machine



Heavy Duty Traction Machine

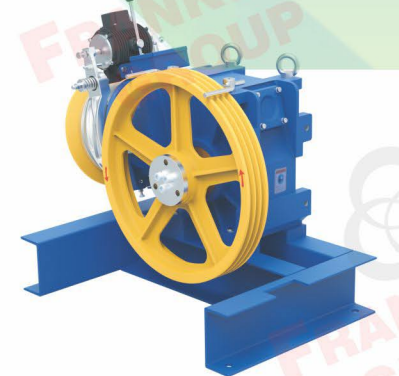

High Speed Traction M/c.

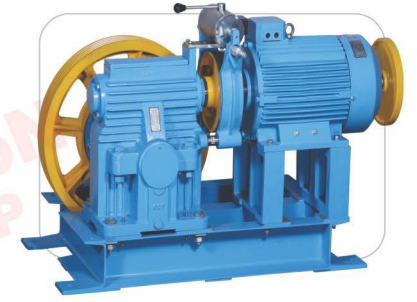

Upper Traction M/c.

Gearless Machine

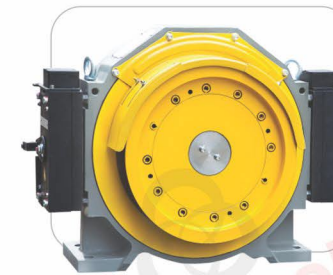

Gearless Machine



Home Lift Single Phase Gearless Machine

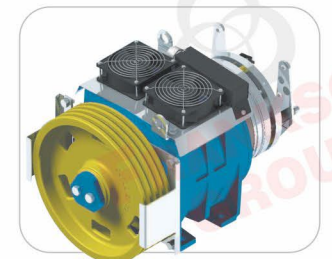

Gearless Machine

High Precision Positioning Control System

V3F Drive



ARL - 500 Controller



MRL Controller

- www.franksonelevator.com
- www.frankson.in
- www.franksongroup.com



CE-4046 Certification



ISO 45001 : 2018 Certified Company



ACCREDITED
Managements
Systems
Certification
Body
MSCD-119



ISO 9001 : 2015 Certified Company
ISO 14001 : 2015 Certified Company



Elevator & Escalator

All Over India & International Branch

Kolkata Branch :

Chinar Park Rajarhat,
(Opposite to Teghoria Loknath Mandir)
K.R. Plaza, Ground Floor, Kolkata - 700157.

Phone : +91 33 2516 0456, 2516 0457,
2986 0651

Hotline : 90075 56123, 97351 20009,
97357 84005

Factory Address:

Malayapur, Raghunathpur Baduria 24 PGS
(North Wst Bengal) Pin - 743401
Phone : 03217 237061 / 9476483337

E-mail : franksonelevator@gmail.com
franksonlift@gmail.com
sales@frankson.in
service@frankson.in
complain@frankson.in



+ 91 9007556123



+ 91 9735784005